

NOTICE!!

These documents have been scanned!

Do not place un-scanned documents beneath this notice!

Do not remove this notice from this file!

GPO Jacket No. 560-102
Print Order 61540
Rise Business Services, LLC
Job=AZ15 5/1/2019



Box Number= AZ15014



Claim Begin-End: AMC439777-AMC439777

1 Initial Receipt



AZ15014-2

AMC439776-AMC440076

United States Department of the Interior
Bureau of Land Management
 DIV OF LANDS, MINRLS & ENERGY
 ONE N CENTRAL AVE
 PHOENIX, AZ 85004 -4427
 Phone: 602-417-9200

Receipt

No: 3666771

| | |
|--|--|
| Transaction #: 3771000 | |
| Date of Transaction: 09/26/2016 | |
| CUSTOMER: | |
| JAMES B WOOLSEY PO BOX 83115 BATON ROUGE, LA 70884-3115 US | |

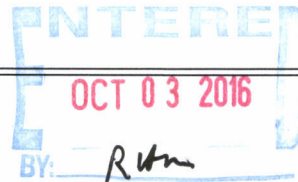

| LINE # | QTY | DESCRIPTION | REMARKS | UNIT PRICE | TOTAL |
|---------------|------|---|---------|------------|-----------------|
| 1 | 1.00 | LOCATABLE MINERALS / MINING CLAIMS-NEW, UNADJUD, ONE OR MORE AUTH NOS / NEW MINING CLAIMS LOCATION FEE CASES: AMC439777/\$37.00 | | - n/a - | 37.00 |
| 2 | 1.00 | LOCATABLE MINERALS / MINING CLAIMS-NEW, UNADJUD, ONE OR MORE AUTH NOS / NEW MINING CLAIMS MAINTENANCE FEE CASES: AMC439777/\$155.00 | | - n/a - | 155.00 |
| 3 | 1.00 | LOCATABLE MINERALS / MINING CLAIMS-NEW, UNADJUD, ONE OR MORE AUTH NOS / NEW MINING CLAIM PROCESSING FEE CASES: AMC439777/\$20.00 | | - n/a - | 20.00 |
| TOTAL: | | | | | \$212.00 |

| PAYMENT INFORMATION | | | |
|---|---------------|--|----------------------|
| NOTE: Items will appear on credit card statement as "Bureau of Land Mgmt CO". | | | |
| 1 | AMOUNT: | 212.00 | POSTMARKED: N/A |
| | TYPE: | CREDIT CARD | RECEIVED: 09/26/2016 |
| | NAME: | WOOLSEY, JAMES B PO BOX 83115 BATON ROUGE LA 70884-3115 US | |
| | CARD NO: | XXXXXXXXXXXX7322 | AUTH CODE: 044416 |
| | NAME ON CARD: | 0619 | |
| | EXPIRES: | 06/2019 | |
| | SIGNATURE: | | |

NOTICE!!

These documents have been scanned!

Do not place un-scanned documents beneath this notice!

Do not remove this notice from this file!

GPO Jacket No. 560-102
Print Order 61540
Rise Business Services, LLC
Job=AZ15 5/1/2019



Box Number= AZ15014



Claim Begin-End: AMC439777-AMC439777

2 Correspondence



AZ15014-2

AMC439776-AMC440076

**NO
DOCUMENTS
FOUND**

NO DOCUMENTS FOUND
NO DOCUMENTS FOUND

NOTICE!!

These documents have been scanned!

Do not place un-scanned documents beneath this notice!

Do not remove this notice from this file!

GPO Jacket No. 560-102
Print Order 61540
Rise Business Services, LLC
Job=AZ15 5/1/2019



Box Number= AZ15014



Claim Begin-End: AMC439777-AMC439777

3 Transfers



AZ15014-2

AMC439776-AMC440076

**NO
DOCUMENTS
FOUND**

NO DOCUMENTS FOUND
NO DOCUMENTS FOUND

NOTICE!!

These documents have been scanned!

Do not place un-scanned documents beneath this notice!

Do not remove this notice from this file!

GPO Jacket No. 560-102
Print Order 61540
Rise Business Services, LLC
Job=AZ15 5/1/2019



Box Number= AZ15014



Claim Begin-End: AMC439777-AMC439777

4 Annual Filings



AZ15014-2

AMC439776-AMC440076

DEPARTMENT OF THE INTERIOR
BUREAU OF LAND MANAGEMENT
MINING CLAIMS

Run Date/Time: 8/20/2018

MC Maintenance Fees Paid Through the BLM Pay Portal
(by Date Paid)

Page 41 Of 316

CBS Receipt: 4231792

Printed For Lead File # AMC439777

Agency Tracking ID: 1533838090

Assessment Year: 2019

Paid On: 8/9/2018

Number of BLM Serial Nr: 1

Total Amount Paid: \$155.00

| Claim Name | BLM Serial No | Lead File No | Amount Paid |
|------------|---------------|--------------|-------------|
| DL #1 | AMC439777 | AMC439777 | \$155.00 |

United States Department of the Interior

Bureau of Land Management
 BUSINESS & SUPPORT SVCS DIV
 ONE N CENTRAL AVE SUITE 800
 PHOENIX, AZ 85004 -4427
 Phone: 602-417-9200

Receipt

No: 4231792

| | |
|---|--|
| Transaction #: 4347083 | |
| Date of Transaction: 08/09/2018 | |
| CUSTOMER: | |
| JAMES B WOOLSEY P.O. BOX 83115 BATON ROUGE, LA 70884 US | |

| LINE # | QTY | DESCRIPTION | REMARKS | UNIT PRICE | TOTAL |
|---------------|------|---|---------|------------|-----------------|
| 1 | 1.00 | LOCATABLE MINERALS / MINING CLAIMS- NOT NEW-UNADJUD, ONE AUTH NO. ONLY / MINING CLAIM MONEY RECEIVED CASES: AMC439777/\$155.00 | | - n/a - | 155.00 |
| TOTAL: | | | | | \$155.00 |

| PAYMENT INFORMATION | | | |
|---|---------------|--|----------------------|
| NOTE: Items will appear on credit card statement as "BLM O Mining Claim". | | | |
| 1 | AMOUNT: | 155.00 | POSTMARKED: N/A |
| | TYPE: | CREDIT CARD | RECEIVED: 08/09/2018 |
| | NAME: | JAMES B WOOLSEY P.O. BOX 83115 BATON ROUGE LA 70884 US | |
| | CARD NO: | XXXXXXXXXXXX5938 | AUTH CODE: 091114 |
| | NAME ON CARD: | JAMES B WOOLSEY | |
| | SIGNATURE: | | |

| |
|---------|
| REMARKS |
| |

This receipt was generated by the automated BLM Collections and Billing System and is a paper representation of a portion of the official electronic record contained therein.

Run Date: 07/31/17

Run Time: 02:19 PM

**DEPARTMENT OF THE INTERIOR
BUREAU OF LAND MANAGEMENT
MINING CLAIMS**

MC Maintenance Fees Paid Through the BLM Pay Portal

CBS Receipt: 3900147

Printed For Lead File # AMC439777

Agency Tracking ID: 1500740313

Assessment Year: 2018

Number of BLM Serial Nr: 1

Paid On: 07/22/2017

Total Amount Paid: \$155.00

| Claim Name | BLM Serial No | Lead File No | Amount Paid |
|------------|---------------|--------------|-------------|
| DL #1 | AMC439777 | AMC439777 | \$155.00 |

United States Department of the Interior
Bureau of Land Management
 BUSINESS & SUPPORT SVCS DIV
 ONE N CENTRAL AVE SUITE 800
 PHOENIX, AZ 85004 -4427
 Phone: 602-417-9200

Receipt

No: 3900147

| | |
|--|--|
| Transaction #: 4009478 | |
| Date of Transaction: 07/22/2017 | |
| CUSTOMER: | |
| JAMES B WOOLSEY P.O. BOX 83115 BATON ROUGE,LA 70884 US | |

| LINE # | QTY | DESCRIPTION | REMARKS | UNIT PRICE | TOTAL |
|---------------|------|--|---------|------------|-----------------|
| 1 | 1.00 | LOCATABLE MINERALS / MINING CLAIMS- NOT NEW-UNADJUD,ONE AUTH NO. ONLY / MINING CLAIM MONEY RECEIVED CASES: AMC439777/\$155.00 | | - n/a - | 155.00 |
| TOTAL: | | | | | \$155.00 |

| PAYMENT INFORMATION | | | |
|---|---------------|--|----------------------|
| NOTE: Items will appear on credit card statement as "BLM O Mining Claim". | | | |
| 1 | AMOUNT: | 155.00 | POSTMARKED: N/A |
| | TYPE: | CREDIT CARD | RECEIVED: 07/22/2017 |
| | NAME: | JAMES B WOOLSEY P.O. BOX 83115 BATON ROUGE LA 70884 US | |
| | CARD NO: | XXXXXXXXXXXX7322 | AUTH CODE: 032112 |
| | NAME ON CARD: | JAMES B WOOLSEY | |
| | EXPIRES: | 06/2019 | |
| | SIGNATURE: | | |

| |
|---------|
| REMARKS |
| |

This receipt was generated by the automated BLM Collections and Billing System and is a paper representation of a portion of the official electronic record contained therein.

NOTICE!!

These documents have been scanned!

Do not place un-scanned documents beneath this notice!

Do not remove this notice from this file!

GPO Jacket No. 560-102
Print Order 61540
Rise Business Services, LLC
Job=AZ15 5/1/2019



Box Number= AZ15014



Claim Begin-End: AMC439777-AMC439777

5 Miscellaneous



AZ15014-2

AMC439776-AMC440076

**NO
DOCUMENTS
FOUND**

NO DOCUMENTS FOUND
NO DOCUMENTS FOUND

NOTICE!!

These documents have been scanned!

Do not place un-scanned documents beneath this notice!

Do not remove this notice from this file!

GPO Jacket No. 560-102
Print Order 61540
Rise Business Services, LLC
Job=AZ15 5/1/2019



Box Number= AZ15014



Claim Begin-End: AMC439777-AMC439777

6 Location Notices-Amendments and Supporting Documents



AZ15014-2 AMC439776-AMC440076

MINING CLAIM STATUS REPORT

Data Entered: 09/03/16 RDM

MTP Checked By: EG
GEO Checked By: EG

LEAD SERIAL NUMBER: AMC 439777 thru AMC _____

NUMBER OF CLAIMS & TYPE:

- 1 LODE
- _____ PLACER
- _____ ASSOCIATION PLACER
- _____ MILL SITE
- _____ TUNNEL SITE

CHARGES:

| | | |
|------------------------------------|----|------------|
| Location Fee @ \$37 = | \$ | <u>37</u> |
| Processing Fee @ \$20 = | \$ | <u>20</u> |
| Maintenance Fee @ \$155 = | \$ | <u>155</u> |
| Add'l Maint Fee for Assoc Placer = | \$ | _____ |
| SUBTOTAL | \$ | <u>212</u> |
| Other Fees | \$ | _____ |
| Other Fees | \$ | _____ |
| TOTAL | \$ | _____ |

TOTAL ACREAGE: _____ Per Claim
(Placer Only)

NUMBER OF LOCATORS: 1

DOCUMENTS RECEIVED VIA : Over-the-Counter [] Mail [] **TIMELY FILED:** Yes [] No []

LEGAL DESCRIPTION:

| | | | | | |
|---|------------|---|------------|-----|-----------|
| T | <u>19S</u> | R | <u>15E</u> | SEC | <u>27</u> |
| T | _____ | R | _____ | SEC | _____ |
| T | _____ | R | _____ | SEC | _____ |
| T | _____ | R | _____ | SEC | _____ |
| T | _____ | R | _____ | SEC | _____ |

BLM [] FOREST SERVICE [] WILDERNESS AREA [] SUBJ TO PL 359: Yes [] No []

SPLIT ESTATE: N/A [] SX [] PX [] OTHER []
SRHA [] Was proper Notice filed if located on SHRA Land? Yes [] No []

RECONVEYED MINERALS ON BLM LAND REQUIRE OPENING ORDER FROM 1944 TO 1993:
Open to Entry On _____ N/A []

COMMENTS/STATUS: VOID [] PARTIALLY VOID [] PVT MINERALS [] WITHDRAWN LANDS []
OTHER [] _____

[] Claimant acknowledges that portions of the following claim(s) site(s) may be void or voidable.

Printed Name of Claimant _____ Signature of Claimant _____

*****FINAL ADJUDICATION*****

DATE 6/5/2017 INITIALS RDM

AMC 439777

LOCATION NOTICE FOR LODE MINING CLAIM

Amendment BLM Serial # _____

NOTICE IS HEREBY GIVEN that the DL #1

_____ lode mining claim has been located

by JAMES B. WOOLSEY whose current mailing address is P.O. BOX #3115

BATON ROUGE, LOUISIANA 70884.

RECEIVED
BLM AZ STATE OFFICE
2016 SEP 26 P 1:29
PHOENIX, ARIZONA
BLM
Date
Stamp

The general course of this claim is NORTH TO SOUTH and it is situated in PIMA

County, Arizona. This claim is 1500' feet in length and 600' feet in width.

20.6 Total Claim Acreage. This claim runs from the location monument on which this location notice is posted on the centerline of the claim approximately 750' feet in a NORTH direction to the NORTH end line and 750' feet in a SOUTH direction to the SOUTH end line. This claim is marked by six monuments, one at each corner and one at the center of each end line of the claim.

The location monument on which this notice is posted is situated within Section 27, Township 19

S, Range 15 E, Gila Salt River Base and Meridian, Arizona and this claim encompasses portions of the following quarter section(s), section(s), Township(s) and Range(s) S.E. 1/4 OF THE N.W. 1/4

OF SECTION 27, T19S, R15E AND THE N.E. 1/4 OF THE S.W. 1/4 OF SEC. 27, T19S, R15E.

Gila Salt River Base and Meridian, Arizona.

The locality of this claim with reference to some natural object or permanent monument and additional information

(if any) concerning its locality are as follows: THE N.E. CORNER OF THE CLAIM LOCATED 1,890'

DUE SOUTH OF THE NORTH SECTION 27 LINE CENTER WHICH IS 2,640' WEST OF THE N.E. SECTION 27 CORNER MARKER, T19S, R.15E. FROM THE N.E. CLAIM CORNER THE EAST SIDE OF THE CLAIM RUNS DUE SOUTH ON THE N-S CENTER LINE The above information is shown on the attached map of SEC. 27 A DISTANCE OF 1500' TO THE S.E. CORNER POST, THEN FROM THE S.E. CORNER 600' DUE WEST DATED AND POSTED on the ground this 24TH day of SEPTEMBER, 2016.

LOCATOR(s) AGENT

Print Name(s) JAMES B. WOOLSEY

Signature(s) [Signature]

TO THE S.W. CORNER POST THEN RUNS FROM THE S.E. CORNER POST 1500' DUE NORTH TO THE N.W. CORNER POST THEN FROM THE N.W. CLAIM CORNER POST 600' DUE EAST TO THE N.E. CORNER POST OF THE CLAIM. THE LOCATION MONUMENT IS LOCATED IN THE EXACT CENTER OF THE MINING CLAIM 300' FROM THE CENTER OF EACH SIDE AND 750' SOUTH OF NORTH CENTER POST AND 750' NORTH OF THE SOUTH END CENTER POST.

Form MCF100
Revised July 2014

ARIZONA 39777

MINING CLAIM MAP

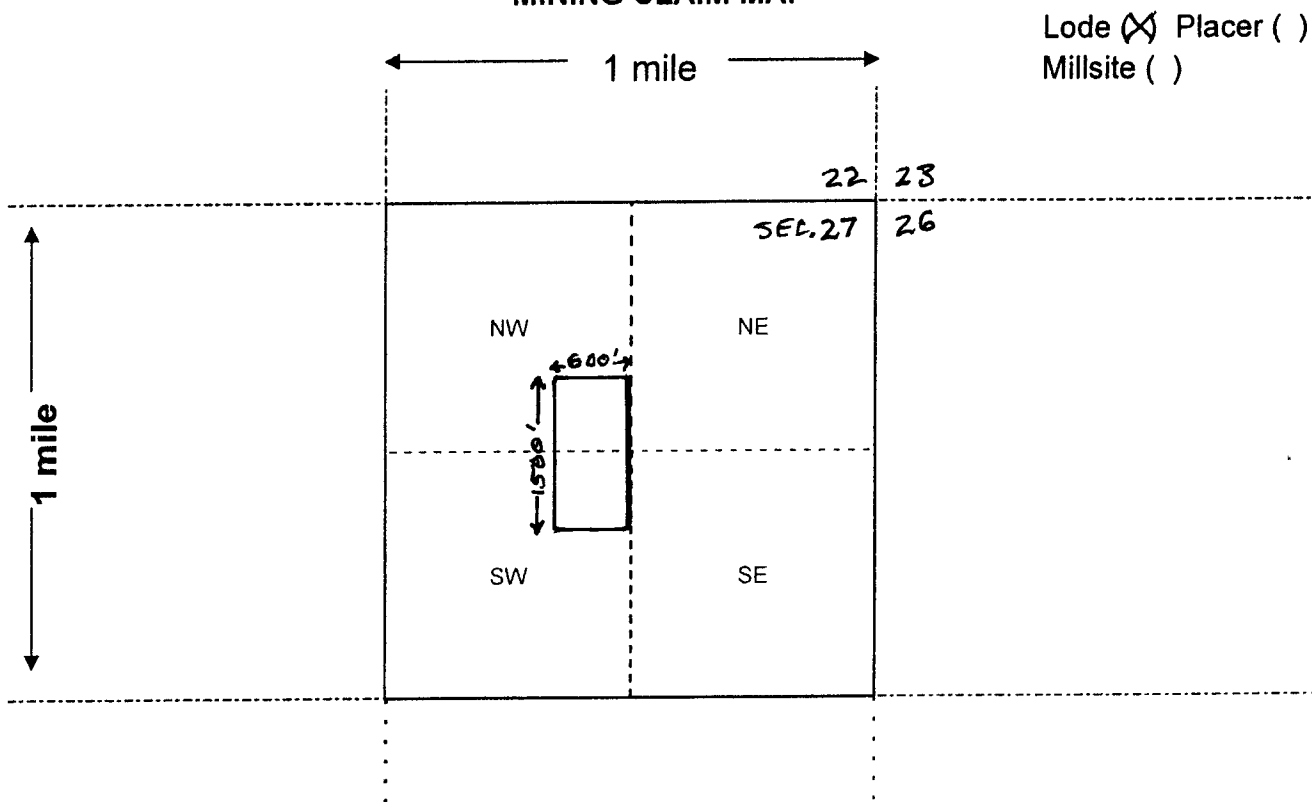

A110439777

Scale: 1" = 2000 feet



1. The above map depicts the DL# 1 mining claim, which is located in Section (s) 27, Township 19 S, Range 15 E, Gila and Salt River Base and Meridian, _____ County, Arizona. Total claim acreage is 20.6

2. The type of corner and location monuments used are as follows: 5' POSTS PLACED 1' IN THE GROUND WITH A ROCK MONUMENT AROUND EACH BASE.

3. The bearings and distances in degrees and feet between claim corners and to a public land survey monument are as depicted on the map.

4. If the claim is a placer or millsite claim with exterior limits conforming to legal subdivisions of the public survey, provide a legal description of the claim _____

Form MCF100a
Revised July 2014

Input Parameters for Geographic Report with Land

System Id = CR

Admin State = AZ

Geo State =

Casetype Begins With

Case Disp Txt = AUTHORIZED, CANCELLED, EXPIRED, PENDING, REJECTED, RELINQUISHED, VOID, WITHDRAWN

Mer Twp Rng =

Section =

Mtrs = 14 0190S 0150E 027, 14 0190S 0150E 999

Commodity =

Commodity Txt =

Pending Org =

Pend Org Decode =

Total Rows Returned: 1

RUN TIME: 01:22 PM

UNITED STATES DEPARTMENT OF INTERIOR
BUREAU OF LAND MANAGEMENT
GEOGRAPHIC REPORT WITH LAND
Sorted by Serial Number

RUN DATE: 09/26/2016
Page 1 of 1

Serial Number: AZA 028555
Total Case Acres: 25,138.000

| <u>Casetype</u> | <u>Case Disp</u> | | | | <u>Sect</u> | <u>Sur Typ</u> | <u>Sur Num</u> | <u>Suff</u> | <u>Subdivision</u> | <u>Act Pend</u> |
|-----------------|------------------|----|-------|-------|-------------|----------------|----------------|-------------|--------------------|-----------------|
| 232107 | AUTHORIZED | 14 | 0190S | 0150E | 027 | FF | | | M&B; | |

